

4. INSTALLATION BLUEBOT APP

Bluebot application

1 Fully charge robot

2 Download Bluebot app

3 Steps for registration

4 Connect robot with app (steps)

1

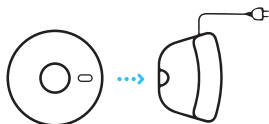

Place the robot on the charging station to charge and make sure it's fully charged before use.

2

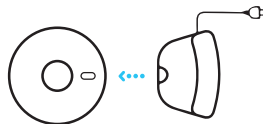

Remove the robot from the charging station.

3



Make sure the robot is on, by holding in the "On button" for a few seconds on top of the robot. Wait until the robot has started fully.

4



Android™ 4.1 or later



iOS 9.0 or later



Download the Bluebot app. The app can be found in the Appstore and Google Play.

5

Register a new account if you are not yet an existing user.

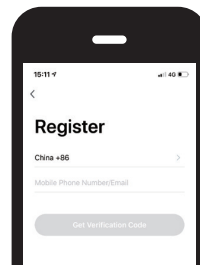

6

Open the Bluebot app and press the "+" icon to add you device.

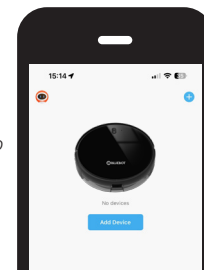

INSTALLATION BLUEBOT APP

7

Select the Bluebot **EZ1**

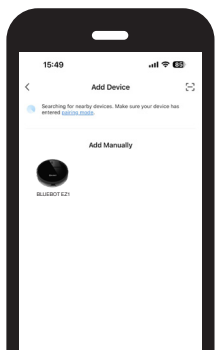

8

Select your 2.4Ghz wifi network, enter the password and press confirm.

Note: a 2.4 Ghz connection only will work.

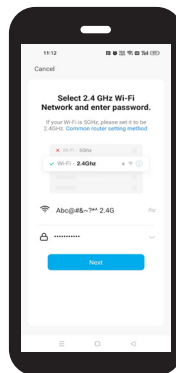

9

Reset the device:
Power on the device.
Power off after 10s and then power on again.
After done, press "Next" to continue.



10

Reset the device:
Hold the Power and Recharge button for 3s.
After done, press "Next" to continue.

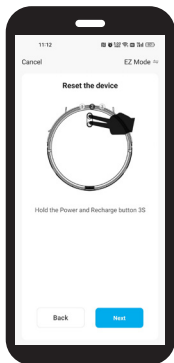

11

Reset the device:
Click: "Confirm the indicator is blinking rapidly.", then press "Next" to continue.



12

Your robot is connecting to the Bluebot app, please wait till connection is complete.

